

RockStar® Data Connectors

RockStar® Data Connectors	IE-LINE Variant 5 RJ45	G.2
	4 - 8 poles	

RockStar® heavy-duty connector plug V5 - RJ45

Straight V5 - RJ45 plug

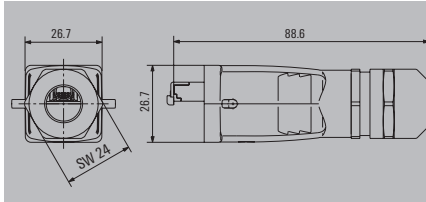

V5-RJ45 plug, angled

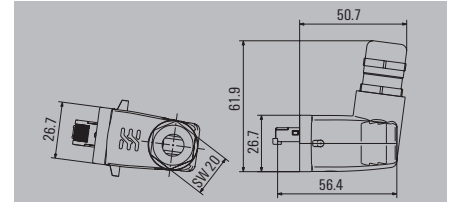

Technical data

Category
Protection degree
Housing main material
Contact surface
Sheath diameter, min. / max.
Plugging cycles
Ambient temperature (operational)
Connector standard
Approvals

Cat.6 _n / Class E _n (ISO/IEC 11801 2010)
IP67
diecast aluminium
Gold over nickel
5 mm / 12 mm
750
-40 °C...70 °C
IEC 61076-3-106 Var. 5, IEC 60603-7-51
CULUS; EAC

Cat.6 _n / Class E _n (ISO/IEC 11801 2010)
IP67
diecast aluminium
Gold over nickel
5 mm / 10 mm
750
-40 °C...70 °C
IEC 61076-3-106 Var. 5, IEC 60603-7-51
EAC

Note

Other approvals for individual parts of the set available

Ordering data - Sets

RJ45 tool-free. AWG 26-22. TIA-A/B-PROFINET
RJ45 tool-free. AWG 26-22. TIA-B
RJ45 Crimp. AWG 27-24

Type	Qty.	Order No.
IE-PS-V05M-RJ45-FH	10	1963200000
IE-PS-V05M-RJ45-FH-B	10	1271250000
IE-PS-V05M-RJ45-TH	10	1963110000

Type	Qty.	Order No.
IE-PS-V05M-A-RJ45-FH	10	1077300000

Note

Ordering data - Empty housings

Note

Type	Qty.	Order No.
IE-PH-V05M	10	1962540000

Type	Qty.	Order No.

Accessories

Dust protection cap



Plug housing protective cap
Spare insert holder

Type	Qty.	Order No.
IE-PP-V05M	1	1968920000
IE-PH-AD-V05M-RJ45	1	1993540000

Type	Qty.	Order No.
IE-PP-V05M	1	1968920000

Note

Plug inserts can also be ordered separately. Refer to Inserts.

Plug inserts can also be ordered separately. Refer to Inserts.

RockStar® heavy-duty connector flange
V5 - RJ45

Module

Coupling

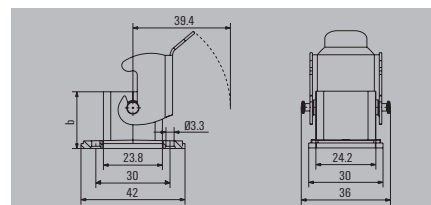
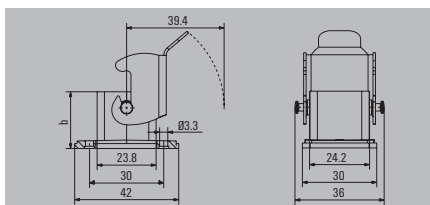

Technical data

Protection degree
Housing main material
Contact surface
Plugging cycles
Ambient temperature (operational)
Connector standard
Connection cross-section, flexible, min. / max.
Connection diameter, flexible, min. / max.
Connection cross-section, solid, min. / max.
Connection diameter, solid, min. / max.
Approvals
Note

IP67
diecast aluminium
Gold over nickel
750
-40 °C...70 °C
IEC 61076-3-106 Var. 5, IEC 60603-7-51
AWG 26 / AWG 22
0.48 mm / 0.76 mm
AWG 24 / AWG 22
0.4 mm / 0.64 mm
CULUS

IP67
diecast aluminium
Gold over nickel
750
-40 °C...70 °C
IEC 61076-3-106 Var. 5, IEC 60603-7-51
CULUS

Ordering data - Sets

TIA-A Cat. 6 _A
PROFINET Cat. 5
Coupling
Note

Type	Qty.	Order No.
IE-BS-V05M-RJ45-FJ-A	10	1963460000
IE-BS-V05M-RJ45-FJ-P	10	1963700000

Type	Qty.	Order No.
IE-BS-V05M-RJ45-C	10	1963510000

Ordering data - Empty housings

Note

Type	Qty.	Order No.
IE-BH-V05M	10	1963530000

Type	Qty.	Order No.
IE-BH-V05M	10	1963530000

Accessories

Dust protection cap
Flange-mounted housing protective cap

Type	Qty.	Order No.
IE-BP-V05M	10	1968930000

Type	Qty.	Order No.
IE-BP-V05M	10	1968930000

Note

Plug inserts can also be ordered separately. Refer to Inserts.

Plug inserts can also be ordered separately. Refer to Inserts.

IE-LINE Variant 5

RJ45 plug inserts, tool-free

- Cat. 6_A
- IP20
- For housing variants 1, 4, 5 and 14

8-wire



4-wire

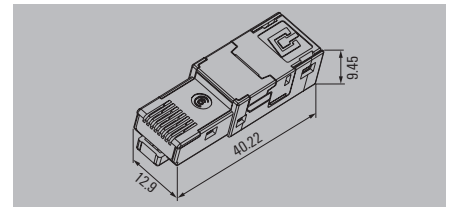
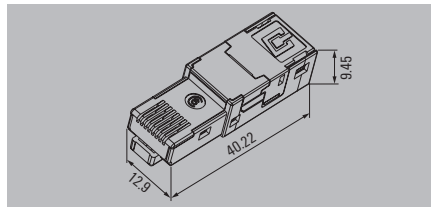

Technical data

Category
Protection degree
Plugging cycles
Shielding
Housing main material
Contact material
Contact surface
Connection cross-section, flexible, min. / max.
Connection diameter, flexible, min. / max.
Connection cross-section, solid, min. / max.
Connection diameter, solid, min. / max.
Wire connection cross-section, finely stranded
Insulation diameter, min. / max.
Humidity
Ambient temperature (operational)
Insulation resistance
Contact resistance
Dielectric strength, contact / contact
Dielectric strength, contact / shield
Current-carrying capacity at 50 °C
PoE / PoE+
Speed
Connector standard
Approvals

Cat.6 _x / Class E _x (ISO/IEC 11801 2010)
IP67 with housing
750
360° all-round enclosure
Zinc diecast
Gold over nickel, Au ≥ 0.8 μm
AWG 26 / AWG 22
0.48 mm / 0.76 mm
AWG 24 / AWG 22
0.4 mm / 0.64 mm
Approval of the cable by Weidmüller necessary
0.85 mm...1.6 mm
-40 °C...70 °C
500 MΩ
≤ 20 mΩ
≥ 1000 V DC
≥ 1500 V DC
1 A
conforming to IEEE 802.3at
10 GBit/s
IEC 60603-7-51
CULUS; EAC

Cat.5 (ISO/IEC 11801)
IP67 with housing
750
360° all-round enclosure
Zinc diecast
Gold over nickel, Au ≥ 0.8 μm
AWG 26 / AWG 22
AWG 24 / AWG 22
0.4 mm / 0.64 mm
Approval of the cable by Weidmüller necessary
0.85 mm...1.6 mm
-40 °C...70 °C
500 MΩ
≤ 20 mΩ
≥ 1000 V DC
≥ 1500 V DC
1 A
conforming to IEEE 802.3at
100 MBit/s
IEC 60603-7-51
CULUS; EAC

Note

Approvals available on request

Ordering data

tool-free	
	TIA-A/B/PROFINET
	TIA-A
	TIA-B
	PROFINET

Note

Type	Qty.	Order No.
IE-PI-RJ45-FH	10	1962730000
IE-PI-RJ45-FH-A	10	1132010000
IE-PI-RJ45-FH-B	10	1132020000

Type	Qty.	Order No.
IE-PI-RJ45-FH-P	10	1132030000

Accessories

Tools	
	Optional pressing tool



Type	Qty.	Order No.
PWZ RJ45	1	1118040000

Type	Qty.	Order No.
PWZ RJ45	1	1118040000

Note

RJ45 plug inserts, crimp

- Cat. 6_A
- IP20
- For housing variants 1, 4, 5 and 14

8-wire

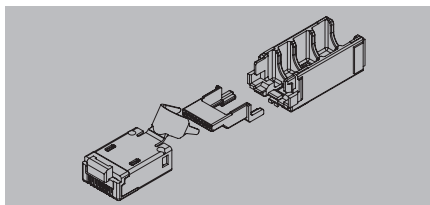

Technical data

Category	Cat.6 _A / Class E _A (ISO/IEC 11801 2010)
Protection degree	IP67 with housing
Plugging cycles	750
Shielding	360° all-round enclosure
Housing main material	Brass, PC UL 94 V0
Contact material	Phosphorus bronze
Contact surface	Gold over nickel, Au ≥ 0.8 μm, Ni 2.54 μm
Connection cross-section, flexible, min. / max.	AWG 27 / AWG 24
Connection diameter, flexible, min. / max.	0.46 mm / 0.61 mm
Connection cross-section, solid, min. / max.	AWG 24 / AWG 24
Connection diameter, solid, min. / max.	0.4 mm / 0.51 mm
Insulation diameter, min. / max.	0.85 mm...1.05 mm
Humidity	0...93 % rel. humidity
Ambient temperature (operational)	-40 °C...70 °C
Insulation resistance	500 MΩ
Contact resistance	≤ 20 mΩ
Dielectric strength, contact / contact	≥ 1000 V DC
Dielectric strength, contact / shield	≥ 1500 V DC
Current-carrying capacity at 50 °C	1 A
PoE / PoE+	conforming to IEEE 802.3af
Speed	
Connector standard	IEC 60603-7-51
Approvals	CURUS; EAC
Note	

Ordering data

Crimp	Type	Qty.	Order No.
	IE-PI-RJ45-TH	10	1962720000
Note			

Accessories

Tools	Type	Qty.	Order No.
 Crimping tool	TT 8 RS MP 8	1	9202800000

Note

IE-LINE Variant 5

RJ45 flange inserts, module

- Cat. 6_A
- IP20
- For housing variants 1, 4, 5, 14 and for FrontCom®

8-wire



4-wire

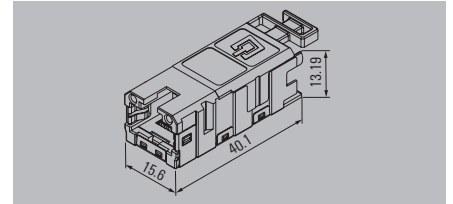
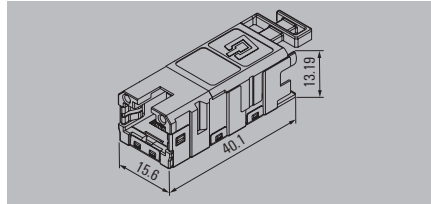
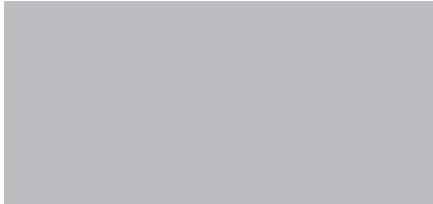
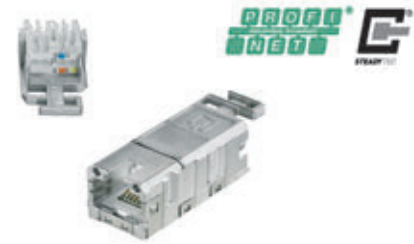

Technical data

Category
Protection degree
Plugging cycles
Shielding
Housing main material
Contact surface
Connection cross-section, flexible, min. / max.
Connection cross-section, solid, min. / max.
Insulation diameter, min. / max.
Connector standard
Ambient temperature (operational)
PoE / PoE+
Approvals

Cat.6 _A / Class E _A (ISO/IEC 11801 2010)
IP67 with housing
750
360° all-round enclosure
Zinc diecast
Gold over nickel, Au ≥ 0.8 μm
AWG 26 / AWG 22
AWG 24 / AWG 22
0.85 mm...1.6 mm
IEC 60603-7-51
-40 °C...70 °C
conforming to IEEE 802.3af
CULUS

Cat.5 (ISO/IEC 11801)
IP67 with housing
750
360° all-round enclosure
Zinc diecast
Gold over nickel, Au ≥ 0.8 μm
AWG 26 / AWG 22
AWG 24 / AWG 22
0.85 mm...1.6 mm
IEC 60603-7-51
-40 °C...70 °C
conforming to IEEE 802.3af
CULUS; GERMLLOYD

Note

Ordering data

tool-free
TIA-A. Cat. 6 _A
TIA-B. Cat. 6 _A
PROFINET Cat. 5

Type	Qty.	Order No.
IE-BI-RJ45-FJ-A	10	1962850000
IE-BI-RJ45-FJ-B	10	1963840000

Type	Qty.	Order No.
IE-BI-RJ45-FJ-P	10	1963830000

Note

Accessories

Tools
Optional pressing tool



Type	Qty.	Order No.
PWZ RJ45	1	1118040000

Type	Qty.	Order No.
PWZ RJ45	1	1118040000

Note

RJ45 flange inserts, coupling

- Cat. 6_A
- IP20
- For housing variants 1, 4, 5, 14 and for FrontCom®

8-wire

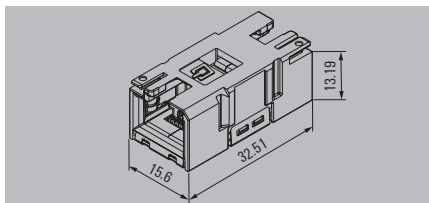

Technical data

Category
 Protection degree
 Plugging cycles
 Shielding
 Housing main material
 Contact surface
 Connection cross-section, flexible, min. / max.
 Connection cross-section, solid, min. / max.
 Insulation diameter, min. / max.
 Connector standard
 Ambient temperature (operational)
 PoE / PoE+
 Approvals

Cat.6_A / Class E_A (ISO/IEC 11801 2010)
 IP67 with housing
 750
 360° all-round enclosure
 Zinc diecast
 Gold over nickel, Au ≥ 0.8 μm
 IEC 60603-7-51
 -40 °C...70 °C
 conforming to IEEE 802.3af
 CULUS; GERMLLOYD

Note

Ordering data

tool-free	
	Coupling
Note	

Type	Qty.	Order No.
IE-BI-RJ45-C	10	1962840000

Accessories

Type	Qty.	Order No.

Note



